

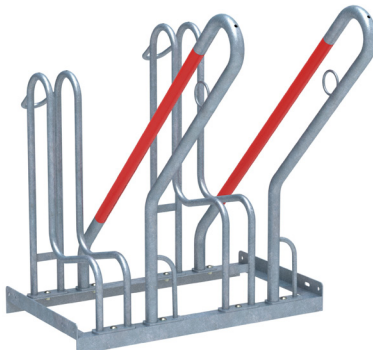

FLOOR BIKE RACK - S02 SERIES



FLOOR BIKE RACK – S02



FLOOR BIKE RACK – S02 + L01

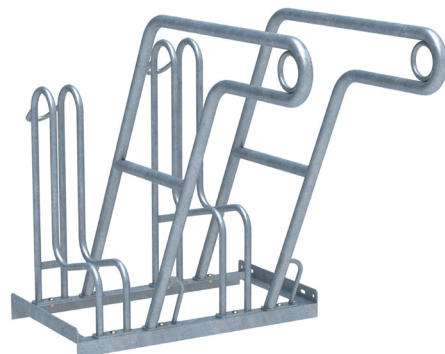

FLOOR BIKE RACK – S02 + L02



SPACE-SAVING



HOT-DIP GALVANISED FINISH



SEAMLESS, STRONG WELD



Specifications and dimensions

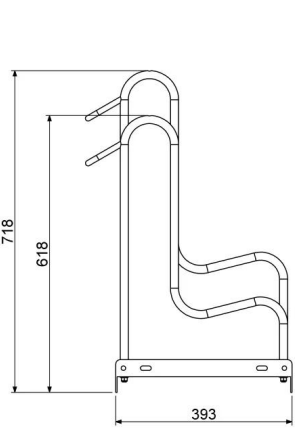

S02 FLOOR BIKE RACK
DIMENSIONS

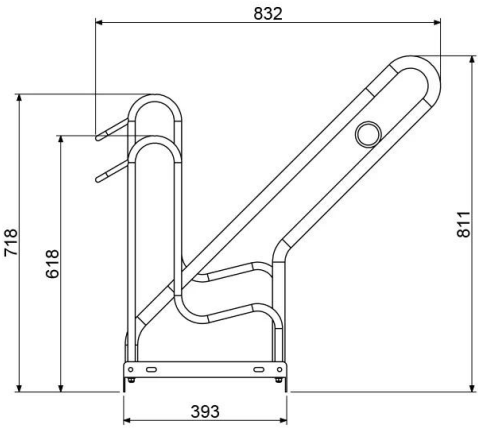

S02+ L01 FLOOR BIKE RACK
DIMENSIONS

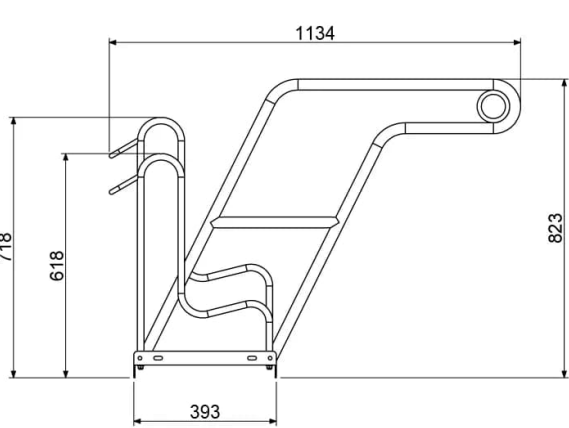

S02+ L02 FLOOR BIKE RACK
DIMENSIONS

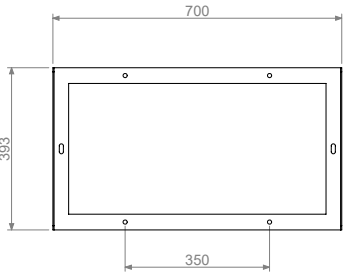

700 MM BASE DIMENSIONS

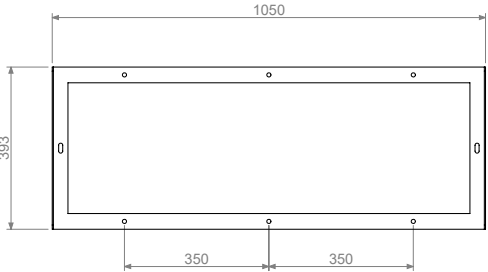

1050 MM BASE DIMENSIONS

BASES	PARKING SPACES	BIKE SPACING (CENTRE TO CENTRE)	MATERIAL & SURFACE TREATMENT
700 mm (27.6")	2 Bikes		
1050 mm (41.3")	3 Bikes		
700 mm (27.6") + 700 mm (27.6")	4 Bikes	350 mm (13.8")	Mild steel & Fully hot-dipped galvanised (after welding)
700 mm (27.6") + 1050 mm (41.3")	5 Bikes		
1050 mm (41.3") + 1050 mm (41.3")	6 Bikes		



MOUNTING HARDWARE



CONNECT BASE TOGETHER



ANGLE FOR FLOOR FIXING



GROUND SPIKES



6-3-102, 27 Pingxiang road,
266011 Qingdao, CHINA



contact@sinoconcept.co.uk
www.sinoconcept.co.uk

Advantages +



SPACE-SAVING

Low and high hoops save space for bike parking.



HOT-DIP GALVANISED FINISH (MINIMUM 80 MICRONS)

Highly corrosion-resistant treatment that prevents rust.

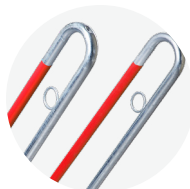

LOCKABLE OPTIONS

Securely lock bike for extra safety.



VERSATILE

Works on one or both sides.



FLEXIBLE BASE OPTIONS

Bases available in multiple lengths (from 2 to 6 bikes or more) and can be joined for larger installations.

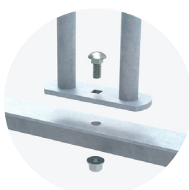

EASY INSTALLATION

Can be placed directly on the ground or fixed to asphalt or concrete with bolts.

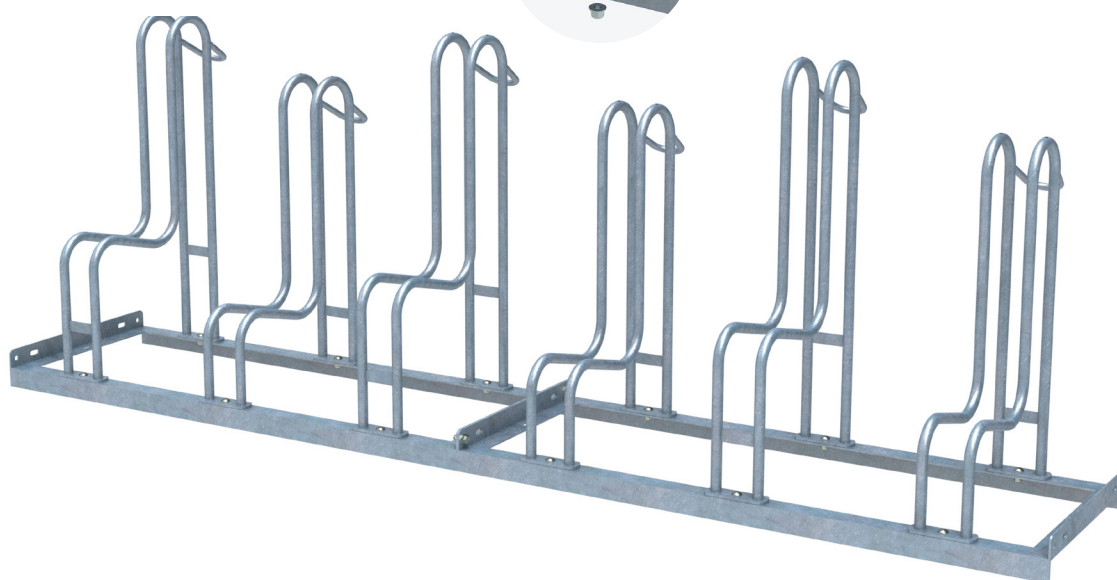

BEST SELLERS

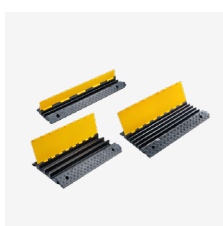

6-3-102, 27 Pingxiang road,
266011 Qingdao, CHINA



contact@sinoconcept.co.uk
www.sinoconcept.co.uk